

# DAPU C800 - Instructions



## About the User Manual

Please refer to this Manual at all times when operating your Display Panel

## Unit Dimension (mm).

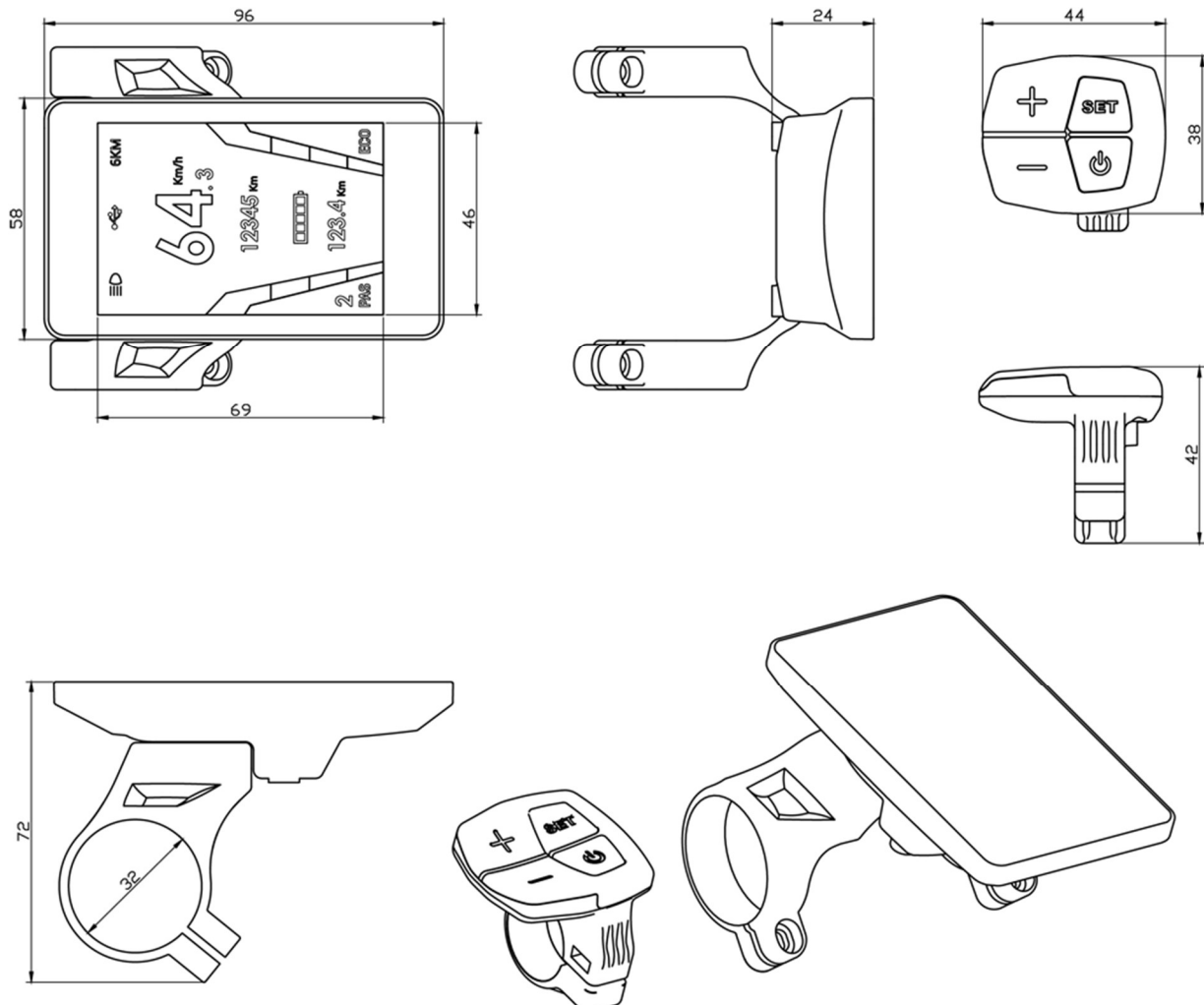

# Button Definition

C800 has four buttons, including ON/OFF, SET, PAS UP and **PAS DOWN**

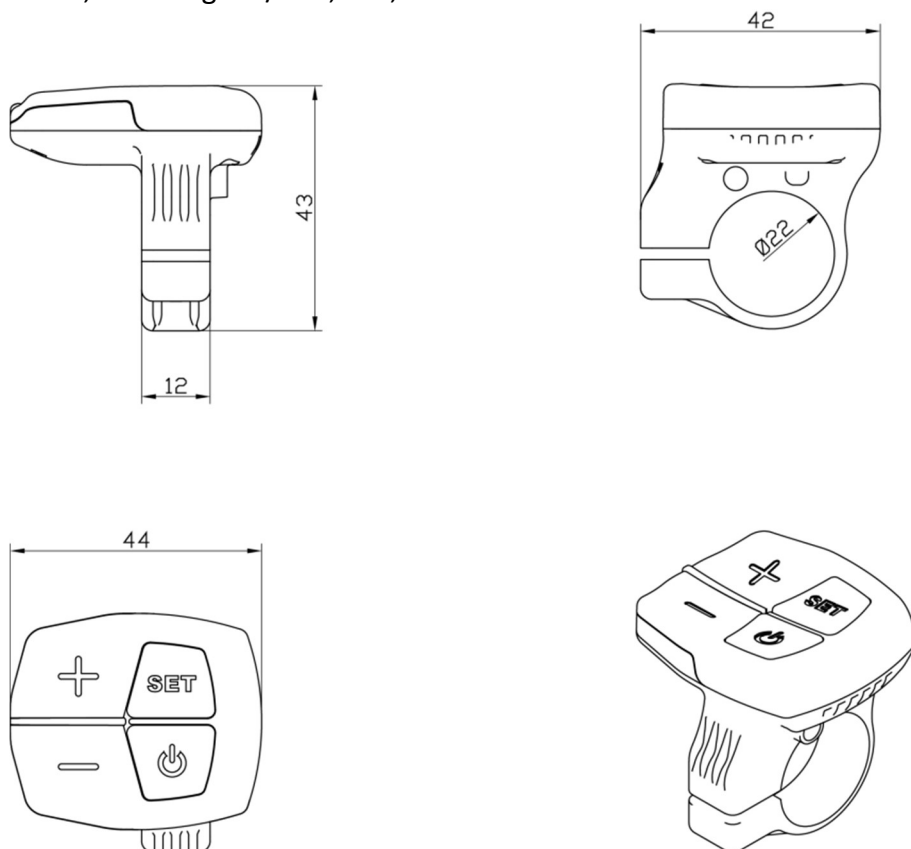

## Function Summary

C800 provides a wide range of functions and indicators to fit the users' needs. The indicated contents are as below.



1. Backlight indicator - With the power on, click the ON/OFF and turn on the backlight.
2. 6KM/H work - Hold the + DOWN for 2 seconds to enter 6km PAS walk mode.
3. Error - Displays the current error code.
4. KM/H&MPH - Select KM/H or MPH for the speed and mileage to display desired mode.
5. Speed display is in MPH or KMH.
6. ODO - The ODO (Odometer) records total distanced travelled whilst POWER is ON. Accumulated distance cannot be cleared.
7. Battery status indicator – indicates amount of charge in battery.
8. Trip Meter - Displays single trip distance.
9. PAS - Displays 'Pedal Activation' level selected..
10. Riding mode selection - There are three modes for riding with arrow selection, including POWER, NORMAL and ECO. The default option is NORMAL.

# Setup Summary

Click SET for 2 seconds to enter the General Settings Interface:

SET 1: Reset trip distance to 0.

MENU		
Display Setting		
➔	1.Trip Clear	N
	2.Brightness	1
	3.Speed Limit	20
	4.Wheel Size	16
	5.Units	MPH
	6.Battery	24V
	7.Advance setting	>
	8.Information	>
	9.Save & Exit	

SET 4: Wheel diameter setting.

MENU		
Display Setting		
	1.Trip Clear	N
	2.Brightness	5
	3.Speed Limit	20
➔	4.Wheel Size	16
	5.Units	MPH
	6.Battery	24V
	7.Advance setting	>
	8.Information	>
	9.Save & Exit	

SET 2: Backlight setting

MENU		
Display Setting		
	1.Trip Clear	N
➔	2.Brightness	5
	3.Speed Limit	20
	4.Wheel Size	16
	5.Units	MPH
	6.Battery	24V
	7.Advance setting	>
	8.Information	>
	9.Save & Exit	

SET 5 KM/H&MPH

MENU		
Display Setting		
	1.Trip Clear	N
	2.Brightness	5
	3.Speed Limit	20
	4.Wheel Size	16
➔	5.Units	KMH
	6.Battery	24V
	7.Advance setting	>
	8.Information	>
	9.Save & Exit	

SET 3: Max speed limited setting

MENU		
Display Setting		
	1.Trip Clear	N
	2.Brightness	5
➔	3.Speed Limit	20
	4.Wheel Size	16
	5.Units	MPH
	6.Battery	24V
	7.Advance setting	>
	8.Information	>
	9.Save & Exit	

SET 6: Volts setting

MENU		
Display Setting		
	1.Trip Clear	N
	2.Brightness	5
	3.Speed Limit	20
	4.Wheel Size	16
	5.Units	KMH
➔	6.Battery	36V
	7.Advance setting	>
	8.Information	>
	9.Save & Exit	

SET 7: Advance setting - Click SET - enter Advance setting

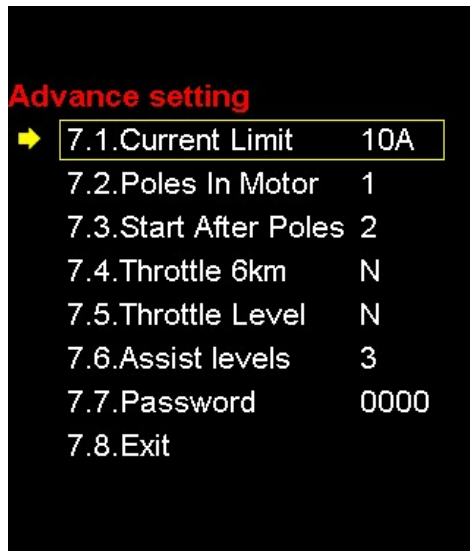

SET 8: Information Displays current software and hardware version, HW = hardware / SW = software

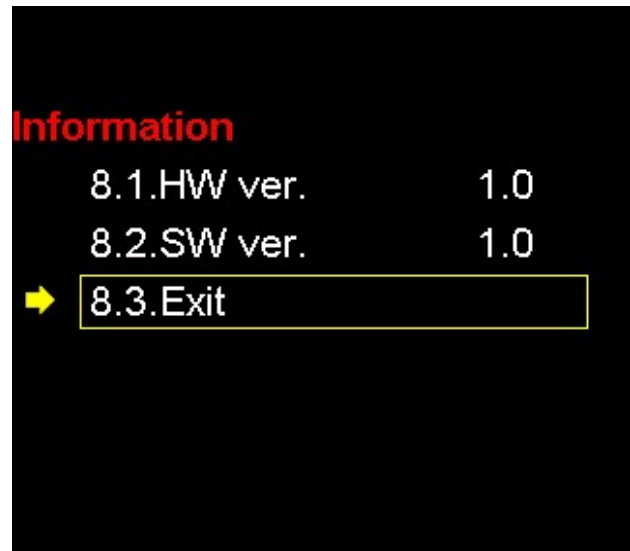

SET 9: Save & Exit: Click “SET” Set up information will be saved and exit

- ❖ When the bicycle is stationary for 5 minutes, the system will go to sleep automatically.
  - Wire order definition
  - Red: Battery+
  - Blue: Weak lock
  - Black: Battery-
  - Green: UART-RECEIVE (RXD)
  - White: UART- SEND (TXD)

## Common Problems and Solutions:

Q: Why the display will not POWER up?

A: Checking the cable connection between display and controller.

Q: How to deal with the error code?

A: Fix it to the maintenance place immediately. If cannot be resolved, you can go to the electric vehicle repair points repair it in a timely manner.

## Quality and Warranty

Any quality problems in normal case and in guarantee period, our company will responsible for the warranty  
The warranty time is 18 months from date of purchasing.

Other items:

The following items are not belong to warranty scope

It cant be demolished

The damager caused by wrong installation or operation

Shell is broken when display is out of the factory

Wire is Broken

Force disaster (such as fire, earthquake, etc) or natural disasters like lightning etc caused by fault or damage

Beyond Warranty period.

## Error Code Table:

9	definition
21	communication display receiving error
22	Current error
23	Throttle error(Start detection)
24	motor no phase position
25	Hall error